

HoldenCopley

PREPARE TO BE MOVED

Charnwood Way, Woodborough, Nottinghamshire NG14 6EW

Offers In The Region Of

Charnwood Way, Woodborough, Nottinghamshire NG14 6EW



STUNNING DETACHED FAMILY HOME

If you are looking for a beautiful home fit for a growing family then this is the place for you.

The property has recently undergone a transformation including a completely new roof and gutter with double insulation, new expensive carpets throughout, oak doors, a new boiler and new bathrooms.

In addition to it being a stunning home, it is also situated in a private location offering an abundance of space both inside and out.

The ground floor holds a family sized lounge, a dining room, kitchen, utility room, a study, downstairs WC and a sun room.

The first floor carries four bedrooms, with the master benefiting from an en-suite, along with a stylish bathroom.

Outside there is a private enclosed garden and a driveway to the front of the property with access to the double garage as well as on road parking for two visitors.

This house must be viewed to be fully appreciated.

MUST BE VIEWED





- Detached House
- Four Bedrooms
- Kitchen & Utility Room
- Three Reception Rooms
- Sun Room
- New Bathroom & En-Suite
- Generous Sized Garden
- Driveway & Double Garage
- Great Family Home
- Must Be Viewed





GROUND FLOOR

Entrance Hall

The entrance hall has a storage cupboard provides access to the accommodation

Kitchen

10'5" x 9'2" (3.2 x 2.8)

The kitchen has a range of base and wall units, a stainless steel sink and a half with mixer taps, an integrated oven with gas hob and extractor fan, an integrated dishwasher, a single fridge with freezer, double glazed window and part tiled walls

Utility Room

7'2" x 4'11" (2.2 x 1.5)

The utility room has a range of base units, a stainless steel sink with mixer taps and space for a washing machine

Lounge

21'3" x 10'5" (6.5 x 3.2)

The lounge has a double glazed window, a feature log burner, TV point and two radiators

Dining Room

10'5" x 9'10" (3.2 x 3.0)

The dining room has a radiator, a double glazed window and access to the rear of the property

Study

8'2" x 6'6" (2.5 x 2.0)

The study has a double glazed window

WC

6'6" x 5'10" (2.0 x 1.8)

This area has a low level flush WC, a hand wash basin, a double glazed window and a radiator

Sun Room

11'9" x 10'9" (3.6 x 3.3)

The sun room has a radiator, a double glazed window and double doors that lead out to the rear

Double Garage

18'8" x 15'5" (5.7 x 4.7)

FIRST FLOOR

Landing

The upper landing has a storage cupboard and provides access to the first floor accommodation

Master Bedroom

15'1" x 10'2" (4.6 x 3.1)

The main bedroom has built in wardrobes, a radiator, double glazed window and access to the en-suite

En-Suite

6'6" x 5'10" (2.0 x 1.8)

The en-suite has a low level flush WC, a hand wash basin, a shower cubicle, a heated towel rail, a double glazed window and tiled walls

Bedroom Two

10'9" x 10'5" (3.3 x 3.2)

The second bedroom has a double glazed window and a radiator

Bedroom Three

10'9" x 10'5" (3.3 x 3.2)

The third bedroom has a double glazed window and a radiator

Bedroom Four

10'9" x 8'6" (3.3 x 2.6)

The fourth bedroom has a double glazed window and a radiator

Bathroom

7'2" x 6'6" (2.2 x 2.0)

The bathroom has a low level flush WC, a hand wash basin, a bath with an overhead shower and shower screen, a double glazed window and tiled walls

OUTSIDE

Front

To the front of the property is a paved driveway for multiple vehicles with access to the double garage

Rear

To the rear of the property is a private enclosed garden with a patio area, a lawn and a range of plants and shrubs

DISCLAIMER

Agents Disclaimer: HoldenCopley, their clients and employees I: Are not authorised to make or give any representations or warranties in relation to the property either here or elsewhere, either on their own behalf or on behalf of their client or otherwise. They assume no responsibility for any statement that may be made in these particulars. These particulars do not form part of any offer or contract and must not be relied upon as statements or representations of fact. 2: Any areas, measurements or distances are approximate. The text, photographs and plans are for guidance only and are not necessarily comprehensive. It should not be assumed that the property has all necessary planning, building regulation or other consents and HoldenCopley have not tested any services, equipment or facilities. Purchasers must make further investigations and inspections before entering into any agreement.

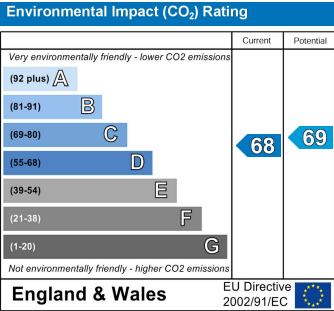
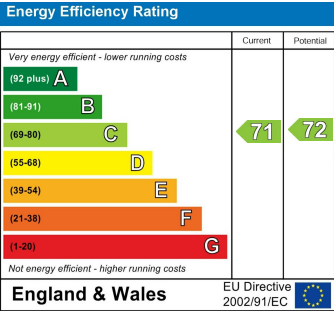

Charnwood Way, Woodborough, Nottinghamshire NG14 6EW

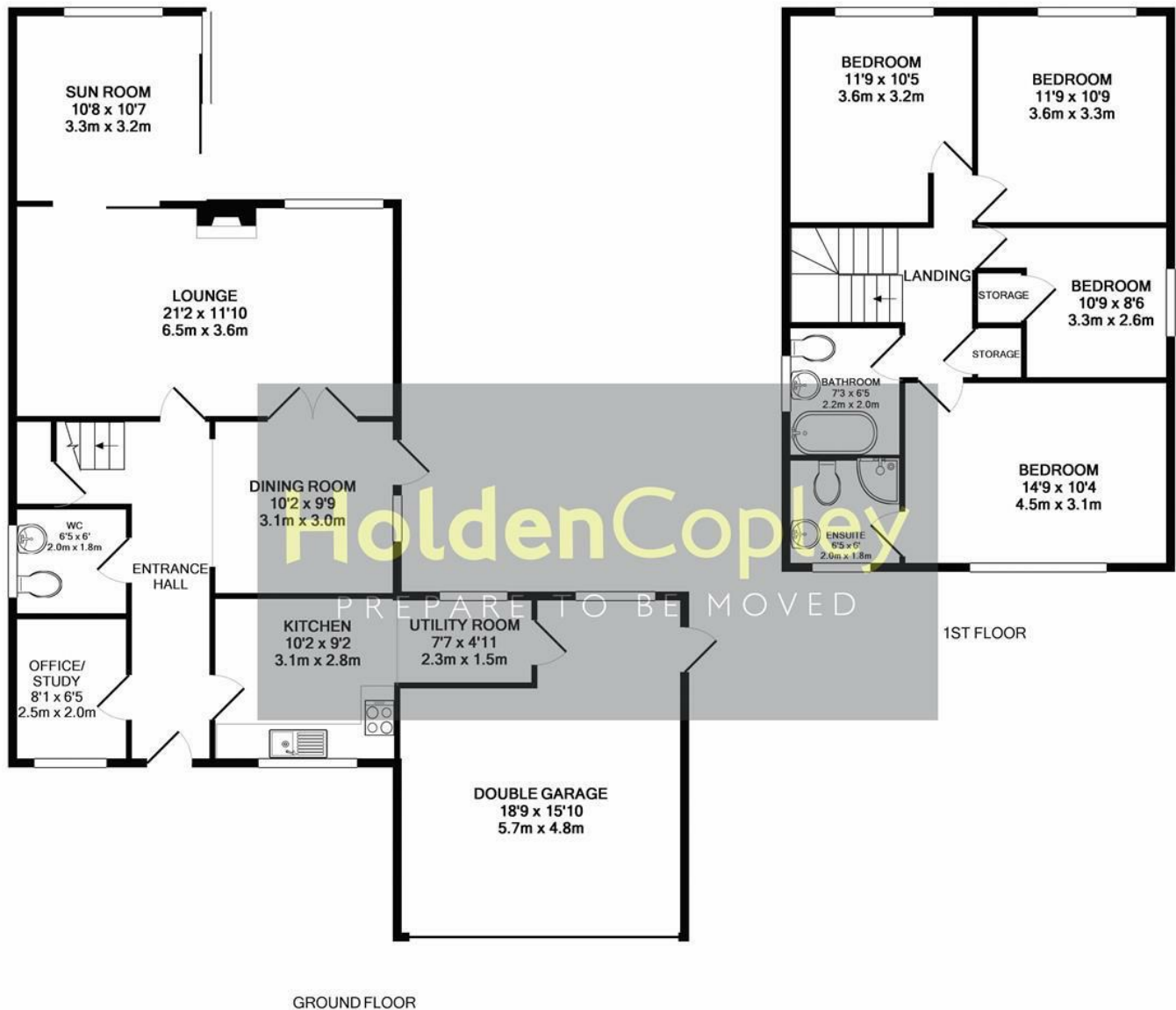

Whilst every attempt has been made to ensure the accuracy of the floor plan contained here, measurements of doors, windows, rooms and any other items are approximate and no responsibility is taken for any error, omission, or mis-statement. This plan is for illustrative purposes only and should be used as such by any prospective purchaser. The services, systems and appliances shown have not been tested and no guarantee as to their operability or efficiency can be given
Made with Metropix ©2019

0115 8969 800

26 High Street, Arnold, Nottinghamshire, NG5 7DZ

sales@holdencopley.co.uk

www.holdencopley.co.uk

Agents Disclaimer: HoldenCopley, their clients and employees I: Are not authorised to make or give any representations or warranties in relation to the property either here or elsewhere, either on their own behalf or on behalf of their client or otherwise. They assume no responsibility for any statement that may be made in these particulars. These particulars do not form part of any offer or contract and must not be relied upon as statements or representations of fact. 2: Any areas, measurements or distances are approximate. The text, photographs and plans are for guidance only and are not necessarily comprehensive. It should not be assumed that the property has all necessary planning, building regulation or other consents and HoldenCopley have not tested any services, equipment or facilities. Purchasers must make further investigations and inspections before entering into any agreement.